

# Lumina®

## Product Data Sheet

**Technical Information Lumina (REF: AL00001) and Lumina-Y (REF: ALY0001)**

**Design:**  
Acrylic  
Aspheric  
Hydrophilic  
Two-element

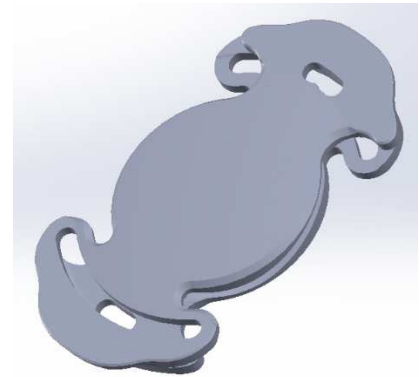
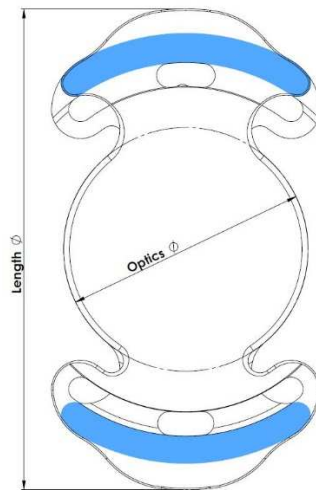

<b>Type</b>	Foldable posterior chamber IOL Two-element with custom haptic sizing
<b>Material</b>	Hydrophilic acrylic with UV-absorber; water content 26% at 35°C, Model Lumina-Y with blue light filter
<b>Specifics</b>	Lens to be implanted into the ciliary sulcus of an aphakic eye, dioptric power and lens size are customized per eye
<b>Dioptric Range</b>	10 to 30 D spherical power (convex-aspheric, aspheric-convex), higher/lower lens power on request; not indicated for eyes with corneal astigmatism of more than 1.0D
<b>Dioptric Step</b>	0.1 D
<b>Optics Ø</b>	5.5 mm to 6.34 mm
<b>Overall Ø</b>	10.85 mm to 12.50 mm
<b>Required biometry data</b>	Anterior Segment OCT, K1/K2, anterior chamber depth, lens thickness and axial length

**Manufactured by:**

AMIPLANT GmbH, Haidling 1, 91220 Schnaittach, Germany, [www.amiplant.com](http://www.amiplant.com)

Phone: +49 9153 924780, E-Mail: [mail@amiplant.com](mailto:mail@amiplant.com)